

PORTA CONTATORI energia elettrica

PORTACONTATORI EN .ELETTRICA TIPO INDUSTRIALE

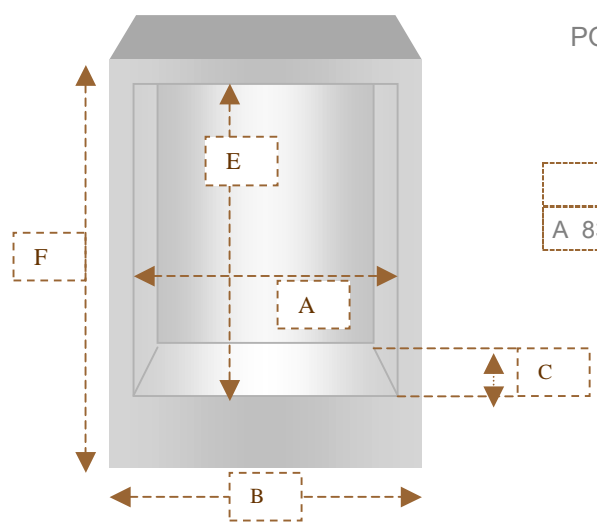

						Peso in kg
A 83 cm	B 95 cm	C 36 cm	E 140 cm	F 167 cm		600

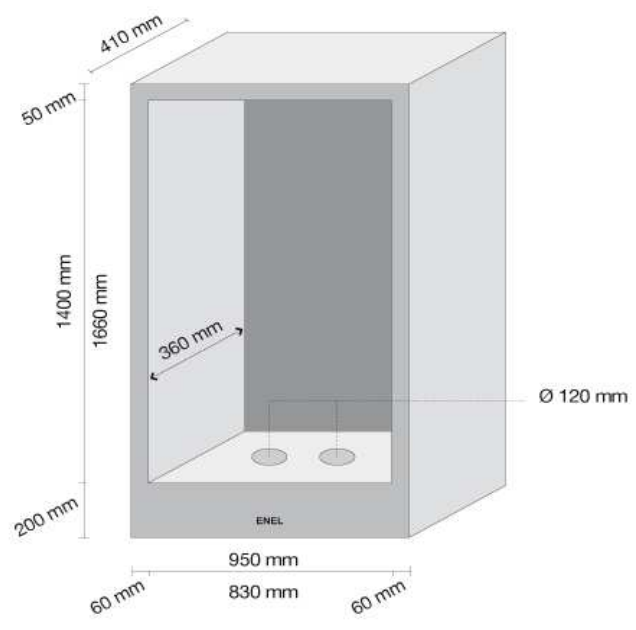

PORTA CONTATORI EN. ELETTRICA. CON COLONNA

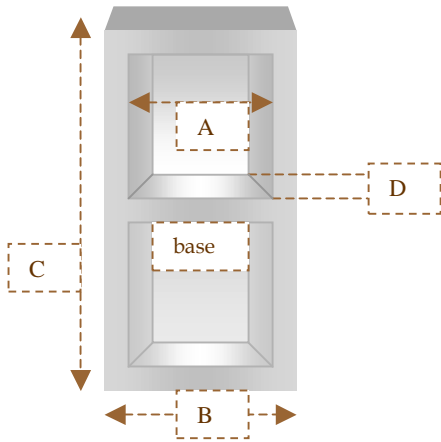

					Peso in kg
singolo monofase	A 26 cm	B 36 cm	C 112 cm	D 22 cm	153,5
doppio e/o trifase	A 42 cm	B 52 cm	C 112 cm	D 24 cm	210

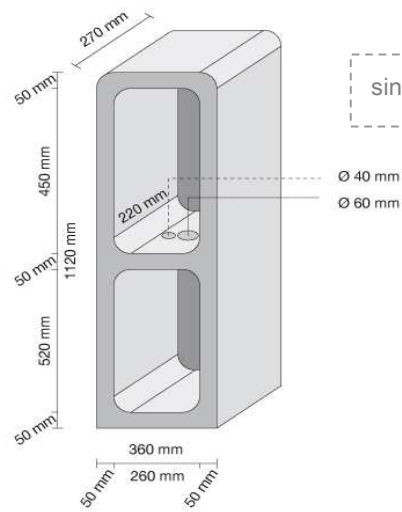

singolo / monofase con colonna

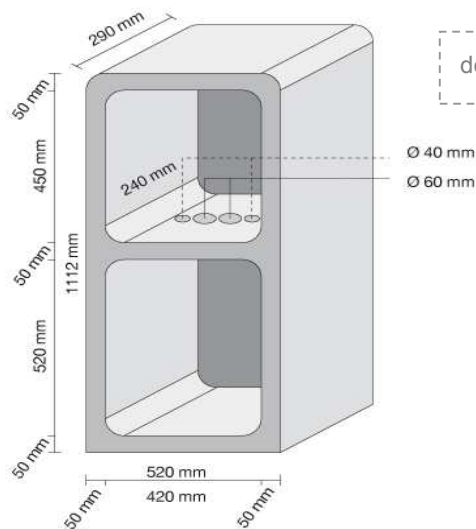

doppio e/o trifase con colonna

PORTA CONTATORI EN. ELETTRICA SENZA COLONNA

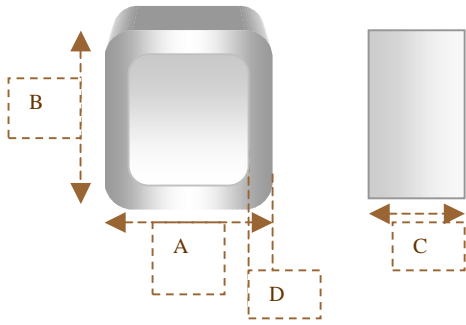

					Peso in kg
singolo monofase	A 35 cm	B 45 cm	C 25 cm	D 5 cm	68,8
doppio e/o trifase	A 52 cm	B 55 cm	C 29 cm	D 5 cm	93,5



singolo / monofase senza colonna

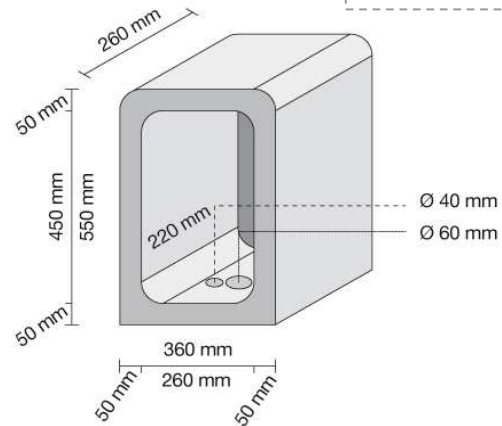

doppio e/o trifase senza colonna

